

W120 3kg Scale



The **W120 Scale** features precision thin-film stain gauge technology, rugged construction, splash resistance, RF immunity, overload protection, and unlimited color and material selection. Rugged medical reagent/waste scale with overload protection from side loads, tension, and compression. The scale features a thin-film load cell that is center balanced and has a long term stability specification of better than 0.1% per year.

Product Specifications:

Maximum Used Load:	3 Kg
Total Height:	.56"
Size (Footprint of Baseplate):	5.0x4.0"
Min. Zero Offset w/Platform:	0.2 mV
Max. Output @ Max. Used Load:	19.8 mV
Min. Working Output Span:	9 mV (0.22 m V/gram
Excitation Voltage:	10V
Load Sensing Element:	Strain Gauge Bending Beam
Bridge Resistance:	5,000 Ω
Operating Temperature Range:	15 to 34°F, -10 to 70°C
Ambient RH Range:	10-90%
Max. Machine Tilt:	2°
Accuracy:	\pm .75 grams, off center loading 1/2 capacity @ 1/2
Distance from Center Edge:	0.150 grams
Overload:	150% of Full Scale or Better
Linearity:	\pm .75 grams
Hysteresis:	\pm 1.50 grams
Repeatability:	\pm .75 grams
Creep:	\pm .75 grams

Features:

- Custom Platforms Available
- RoHs Scales Available Upon Request

Applications:

- Medical
- Reagent
- Waste



STRAIN MEASUREMENT DEVICES

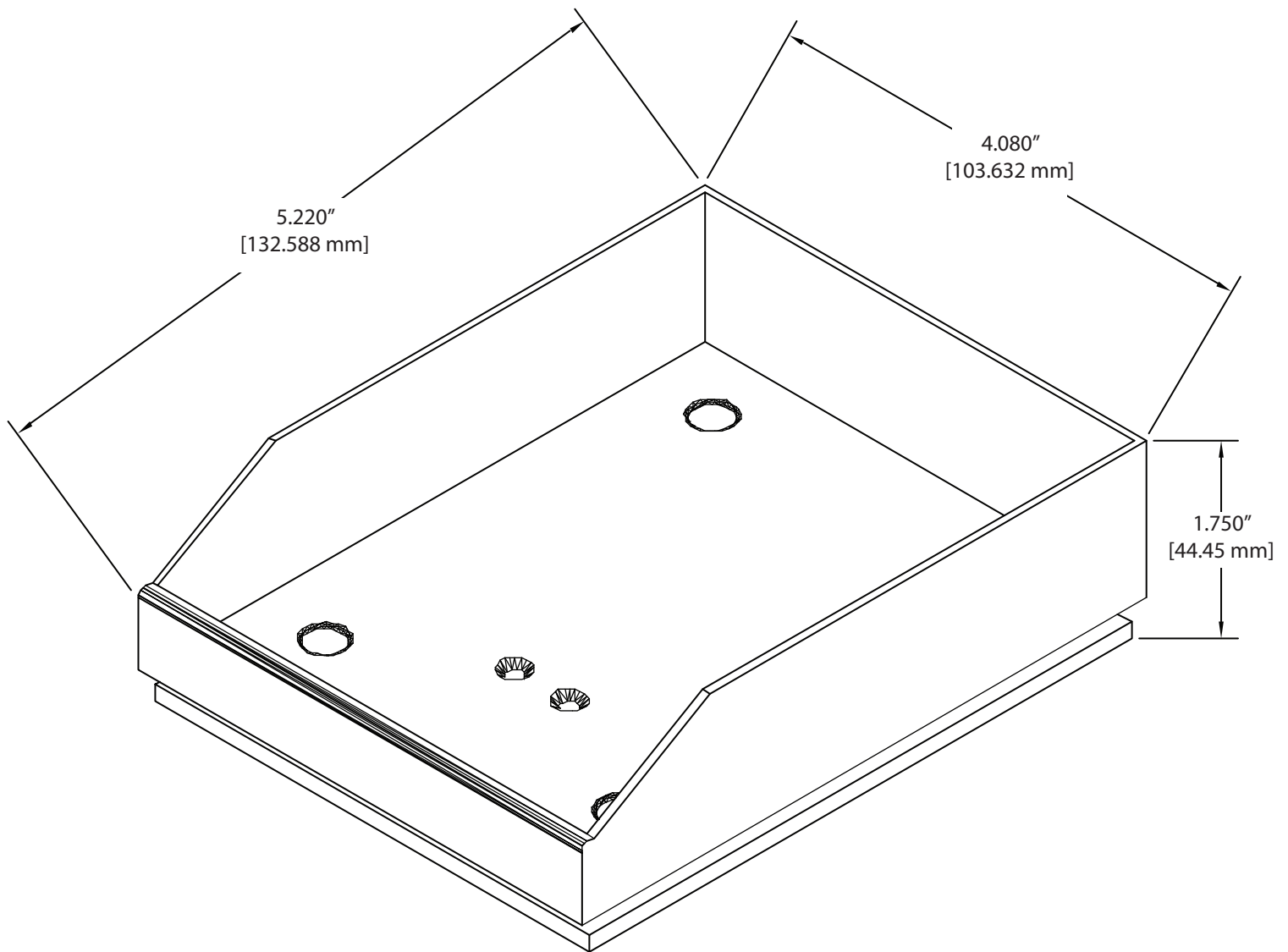

USA
Strain Measurement Devices
55 Barnes Park North, Wallingford, CT 06492
sales@smdsensors.com | (203) 294-5800

www.smdsensors.com

Europe
Strain Measurement Devices
Bury Road, Chedburgh, Bury St Edmunds IP29 4UQ
sales@smdsensors.co.uk | +44 (0)1284 852 000