

P30 Noninvasive Pressure Sensor



This Non Invasive Pressure sensor is a small-diameter tubing sensor consisting of two parts assembled together. One part is a low-cost disposable flow module, while the other is a reusable pressure sensor.

The sensor can be used to detect pressure in tubing up to 0.25" in diameter. Ideal for high sanitary applications in biopharmaceutical and medical device industries.

Product Specification:

Pressure Range:	0-30 psi
Body Material:	6061-T6 Aluminum, Black Anodize
Pressure Interface:	SMD7615 Disposable Membrane Housing
Cable Part Number:	SMD7720 (18" Length, Male Molex connector one end, other end flying leads)
Overload Protection:	>20 Pound Force
Supply Voltage:	5-24 VDC
Sensor Pinout:	Function
Pin #	
(Molex 53047-0510)	
1	VCC
2	I ² C SCL
3	I ² C SDA
4	Analog Out
5	GND
Performance Specifications:	
Output	I ² C and 0-5 V Analog
Zero psi	3277 (I ² C Counts 0.5 VDC)
Span (30 psi)	26214 (I ² C Counts 4.0 VDC)

Features:

- Accuracy
- Disposable Dome
- Low Power Consumption
- Long Term Stability
- Noninvasive
- Economical

Applications:

- Medical Devices
- Industrial Fluid Handling
- Food Processing
- Laboratory Instruments

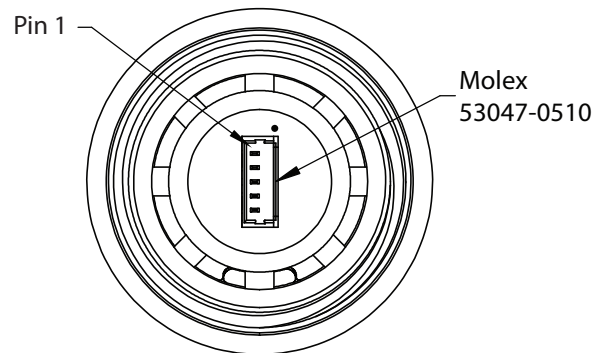
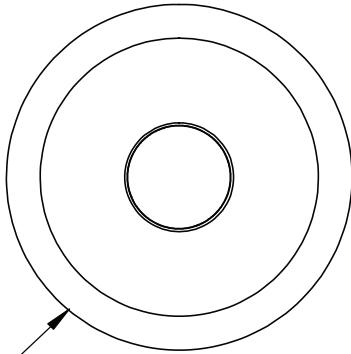
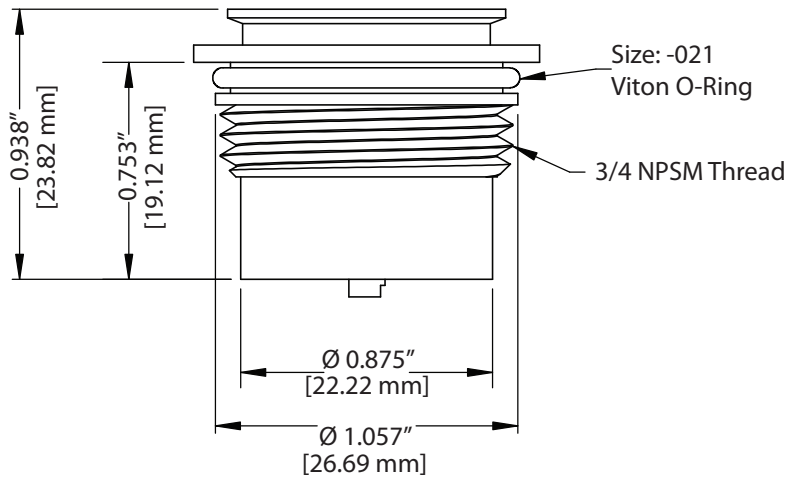
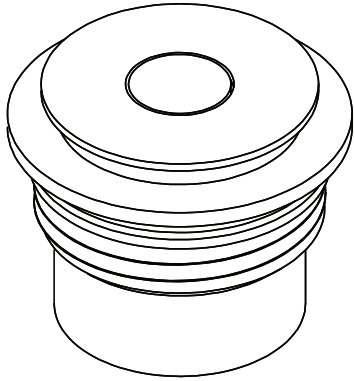

Disposable Pressure Isolator (Snap On)

